

ASSEMBLY INSTRUCTION MANUAL

#60-125 WIRE BASKET TOPPER

FOR DOUBLE RACK

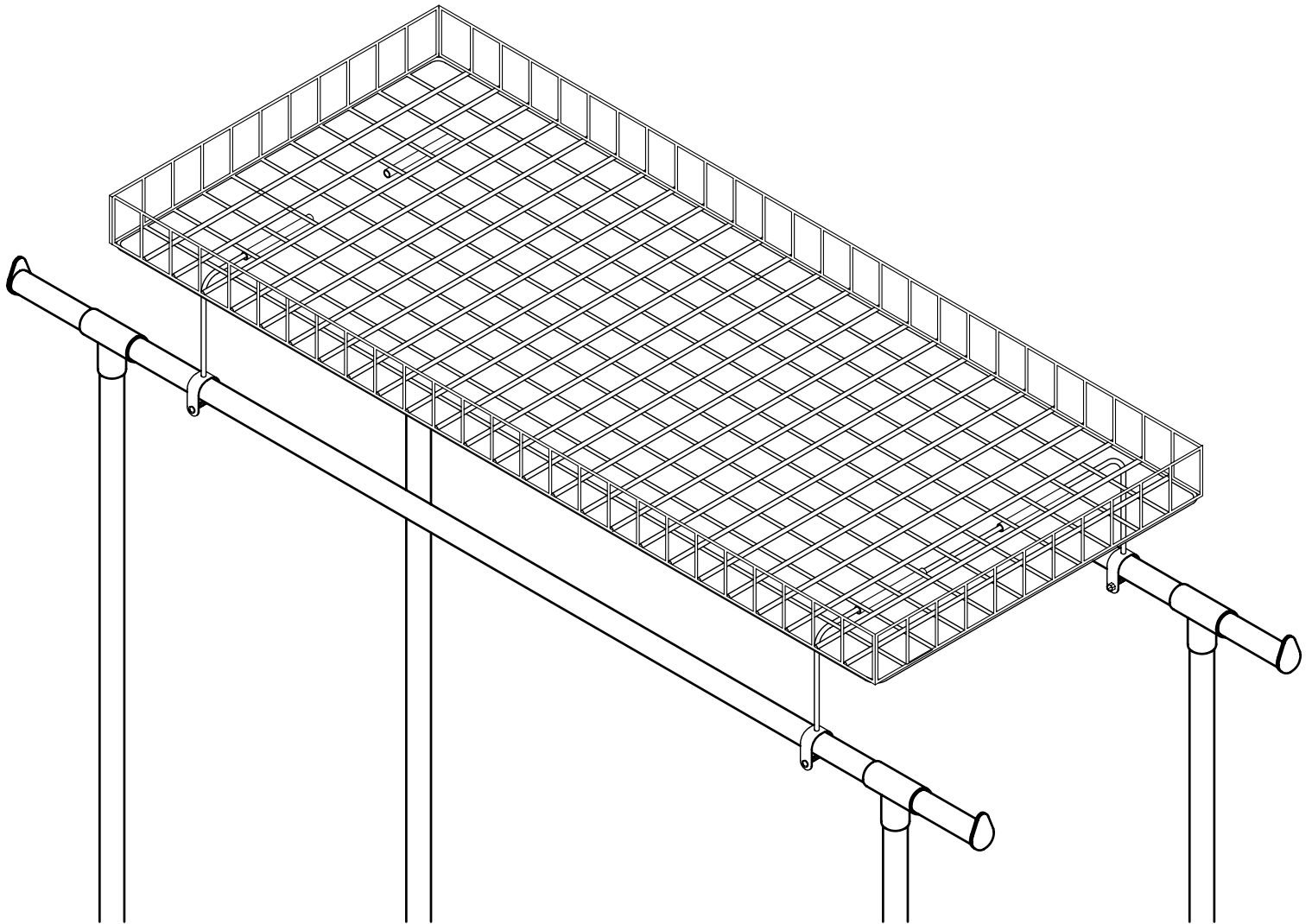

Final : 9/24/10

9801 PAGE AVENUE
ST. LOUIS, MO. 63132-1428
TEL: (314) 427-8887
or (800) 823-8887
FAX: (314) 427-0004
or (800) 823-0004



60-125 ASSEMBLY INSTRUCTION

WIRE BASKET TOPPER FOR DOUBLE RAIL RACK

PARTS IN CARTON:

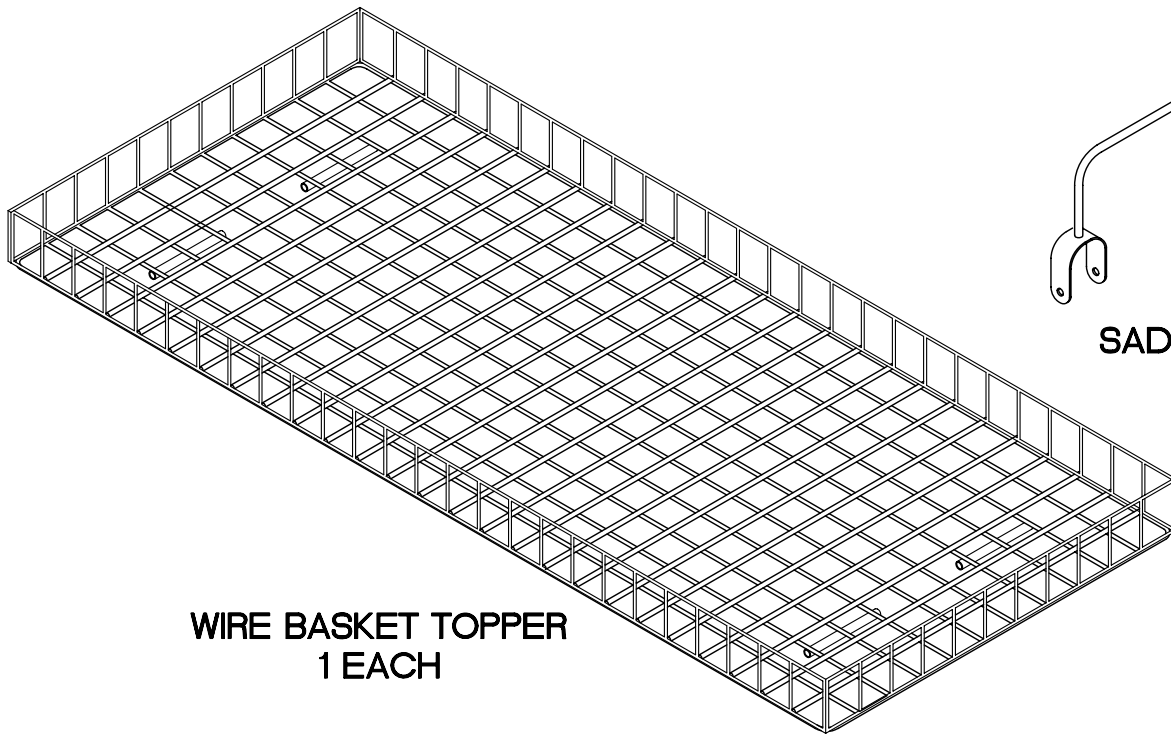

WIRE BASKET TOPPER
1 EACH

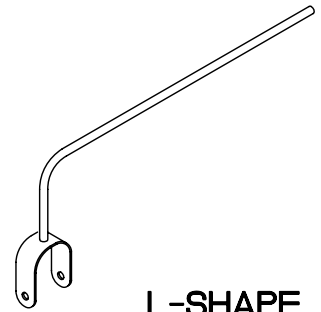

L-SHAPE
SADDLE BRACKET
4 EACH

HARDWARE IN BAG

NOTE: HARDWARE BELOW ARE SHOWN ACTUAL SIZE:
IF YOU ARE NOT SURE WHICH PART IS CORRECT
THEN PLACE PIECE ON TOP OF DRAWING BELOW
FOR HELP DURING ASSEMBLY.

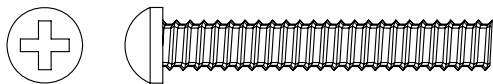

PHILLIP ROUND HEAD BOLT
4 EACH

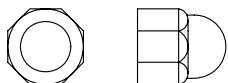

ACORN HEX-NUT
4 EACH

TOOL (NOT SUPPLIED)

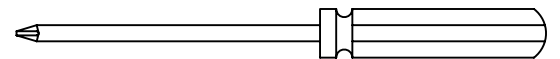

PHILLIP'S SCREW DRIVER

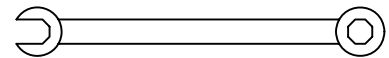

3/8" OPEN - BOX END WRENCH



60-125 ASSEMBLY INSTRUCTION

WIRE BASKET TOPPER FOR DOUBLE RAIL RACK

ASSEMBLY STEPS:

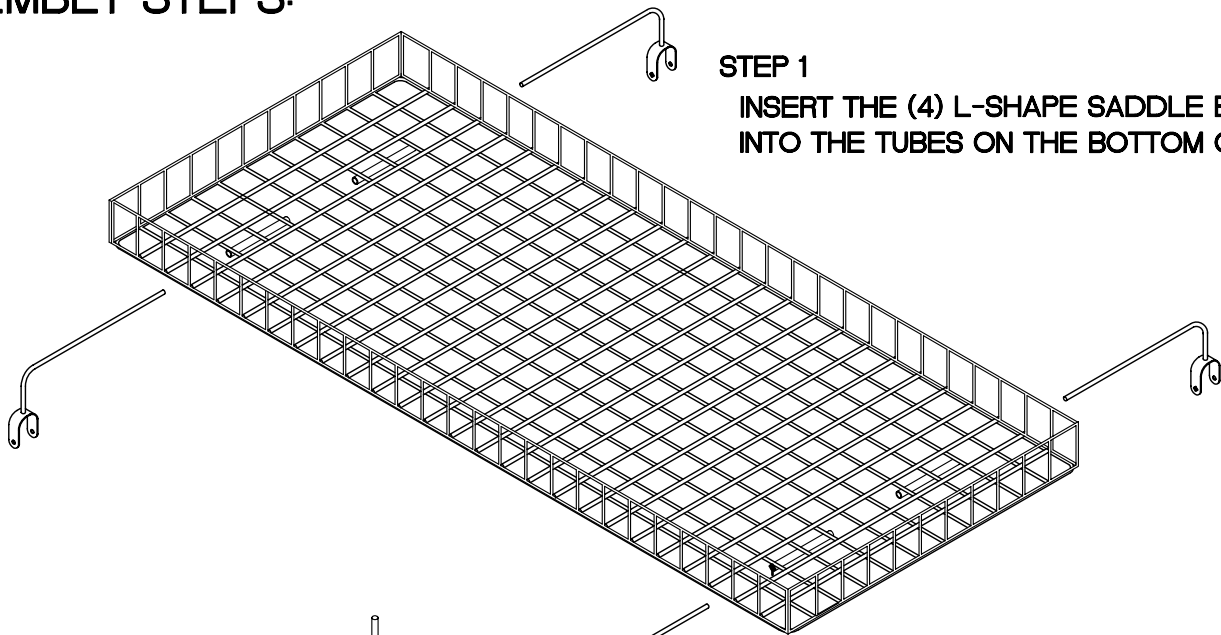

STEP 1

INSERT THE (4) L-SHAPE SADDLE BRACKETS INTO THE TUBES ON THE BOTTOM OF BASKET

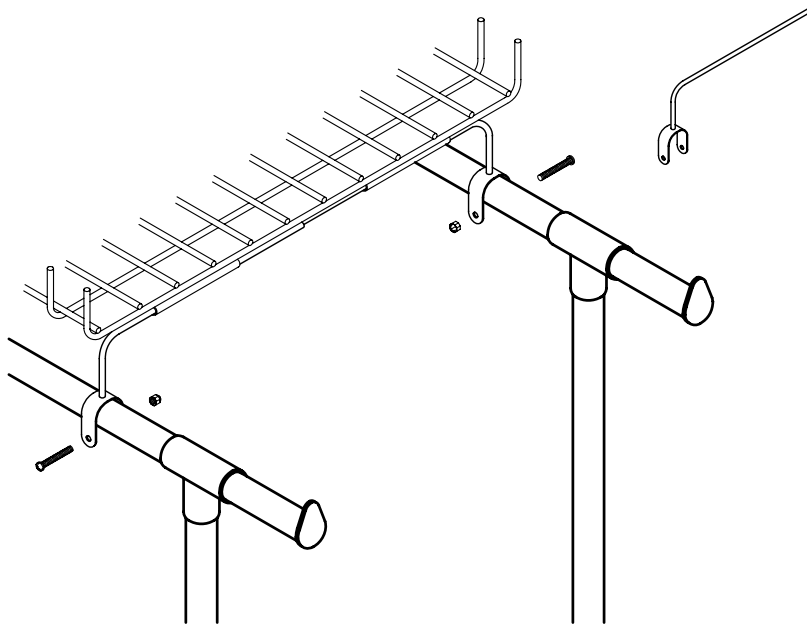

STEP 2

SET THE BASKET WITH SADDLE BRACKETS OVER THE DOUBLE RAIL RACK AS SHOWN ABOVE. INSERT BOLT THROUGH SADDLE AND SCREW THE ACORN NUT ONTO THE SCREW. DO NOT OVER TIGHTEN. INSTALL ONE END AT A TIME, AFTER ALL (4) BRACKETS ARE INSTALLED. MOVE THE RACK SO THAT THE BRACKETS ARE STRAIGHT UP AND DOWN. TIGHTEN THE BOLTS ONE AT A TIME USING THE BOX END WRENCH AND PHILLIPS SCREW DRIVER.

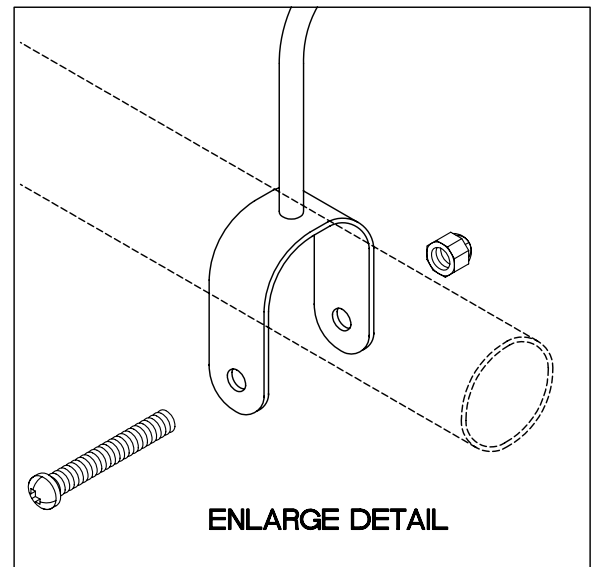

UNIT IS COMPLETE
SEE COVER FOR THE ASSEMBLED UNIT

